

Note:

On the cover sheet you can find warning information, and an explanation of the symbols and terms used, together with the exclusion of liability.

Mount the keypad before installing the electronic lock. All the keypads of the Primor series can be used. Details on installing the keypads are given in the "Primor installation instructions (see sections 3 to 7)".

Contents

General	2
Preparation for installation	3
Installation dimensions	3
Preparation of the boltwork / door	4
Installation	5
Wiring / installation	6
Connection of an analog keypad	6
Connection P- signal plus / UART	7
Function test.....	7
Input of the opening code	7
Keypad test	8
System setup	8

General

Locks of the Anchor 4000 series have standard installation dimensions and can be mounted in all 4 installation positions (right, left, top, bottom). They have been designed for a boltwork with two blocking edges, i.e. for the force to be applied only on only the flank of the bolt.

They are intended to be installed in safes made of metal.

The electronic lock requires no maintenance in a normal residential or office environment. We recommend a security and function test of the electronic lock after around 10,000 closings.

It is essential that the lock is protected against attacks from outside. We recommend that you protect against access the security-relevant parts of the high-security lock also when the door of the container that holds the valuables is open.

It is not permissible to use two locks of the same type in connection with analog keypads without any additional components for locking state detection.

Do not apply any lubricants or other substances to the lock.

Ensure that the load limits are not exceeded at any time.

You can find the corresponding values in Annex C "Technical data".

The installation of the electronic lock is permitted in the area of cutouts of the safe door according to the drawing below.

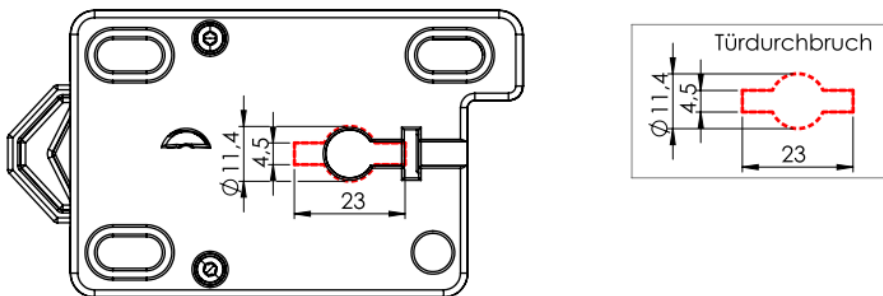

Always use the following sequence for installation:

- Check the preconditions for installation
- Wiring / installation of the cables
- Set up the power supply
- Function test of the locking mechanism
- Make all the settings (user system, Dualcode, inputs and outputs, delay time)

Preparation for installation

Installation dimensions

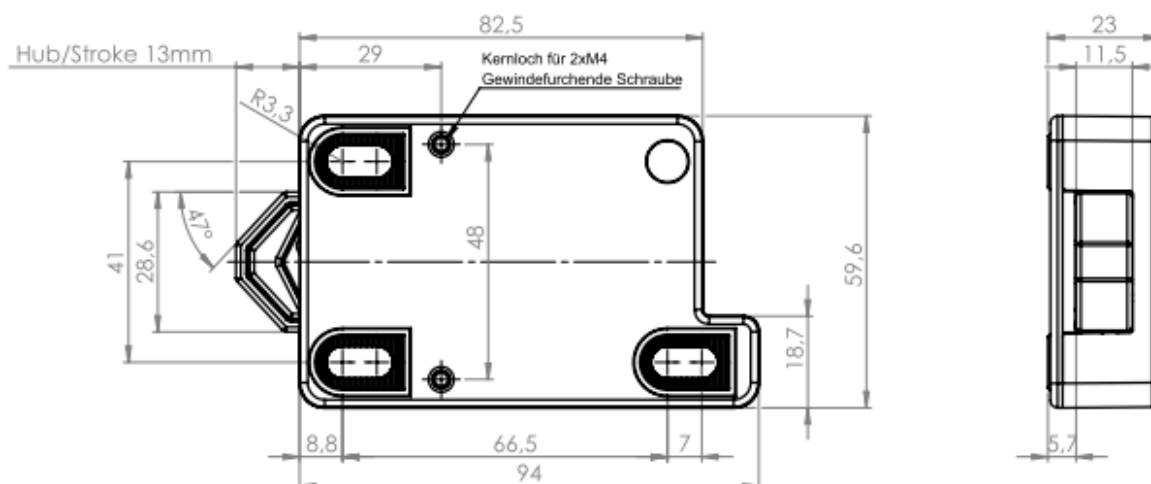

Preparation of the boltwork / door

For installation of the lock there must be three threaded holes with 5 mm screw-in depth for attachment to the boltwork or within the safe door. The electronic lock is to be attached with the supplied M6 or 1/4"

screws or cylinder screws (minimum strength class 8.8).

The length of the screws must be 25 mm or more so that a minimum screw-in depth of 5 mm is attained.

Installation

The included toothed lock washer must be used to attach the lock. To do this, turn the screws by a few turns, but only so far that movement in the direction of the bolt is still possible. Push the lock in the direction of the bolt without any play up to the edges of the strikers of the boltwork and tighten up the retaining screws. The position must be selected such that the sliding striker of the boltwork runs over the entire opening path

on the slanted sliding surfaces of the bolt and when fully open on the bolt head.

Tighten up the retaining screws so as to ensure a permanent and secure hold. The screw heads must be within the recesses provides. Mounting with a screwing-in direction from the chassis floor is not permitted.

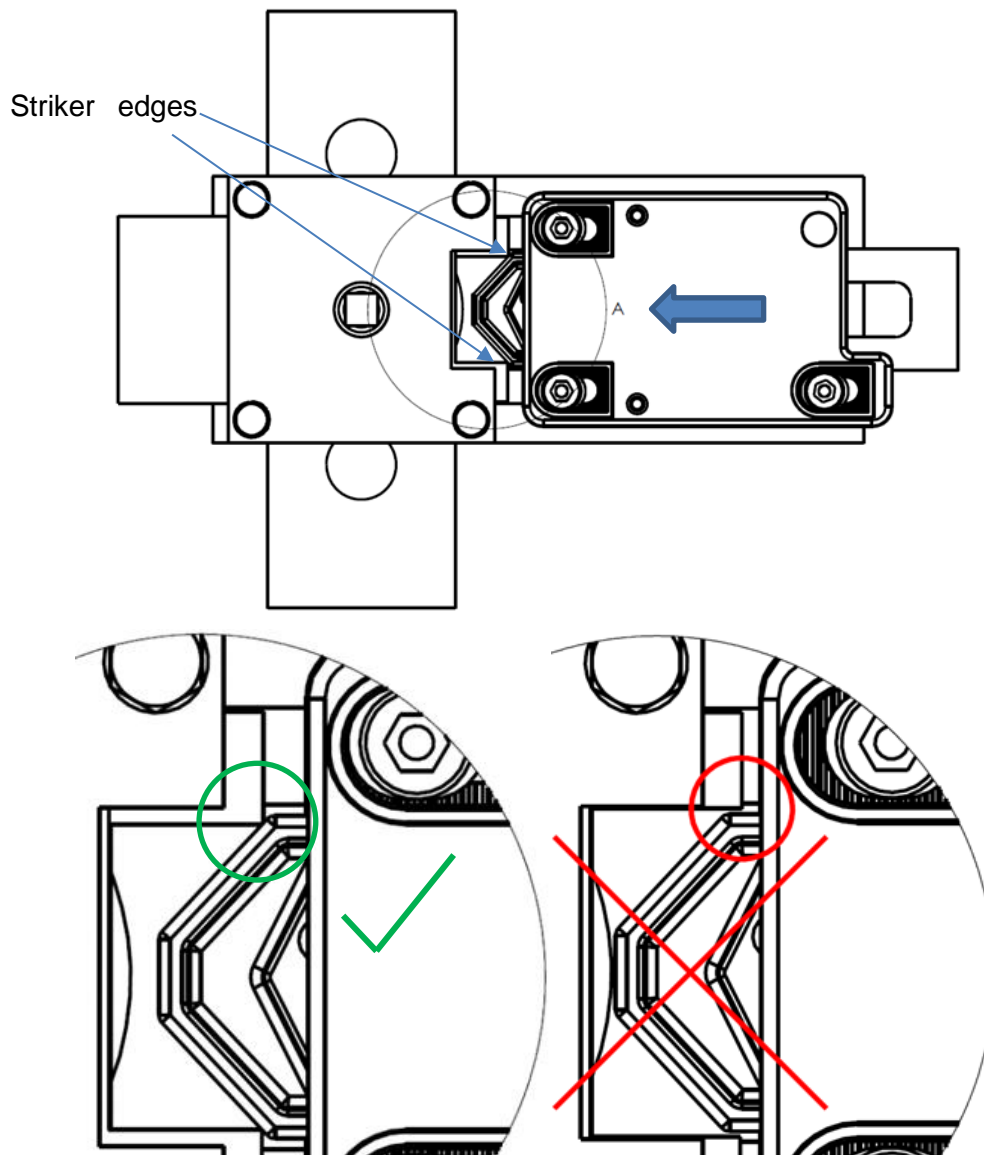

Tighten up the fastening screws to a maximum torque of 10 Nm. We recommend the use of a bolt locking agent (adhesive) to prevent the screws from coming undone by themselves.

The bolt of the lock may not be under tension or pressure after installation.

Wiring / installation

If the lock is operated outside the area of validity of the VdS, then signal boxes, external power supplies, etc. can be used with the Anchor in addition to all the analog

keypads that are compatible with the Primor series. The VdS approval is restricted to operation with input units of the Primor FS, FL, RO and RE series.

Cut off the power supply, including that from batteries, before starting any work or making any changes to the wiring between the lock, keypad or signal boxes.

Connection of an analog keypad

As supplied, only the interface for an analog keypad from the Primor series is active. If the lock is to communicate with a digital input unit, i.e., an "intelligent" one, then additional settings are required in the setup menu [6] in addition to the selection of the corresponding interface or socket.

You can find the corresponding commands in the user manual.

You can find information on inserting the battery in the operating manual of the corresponding Primor keypad.

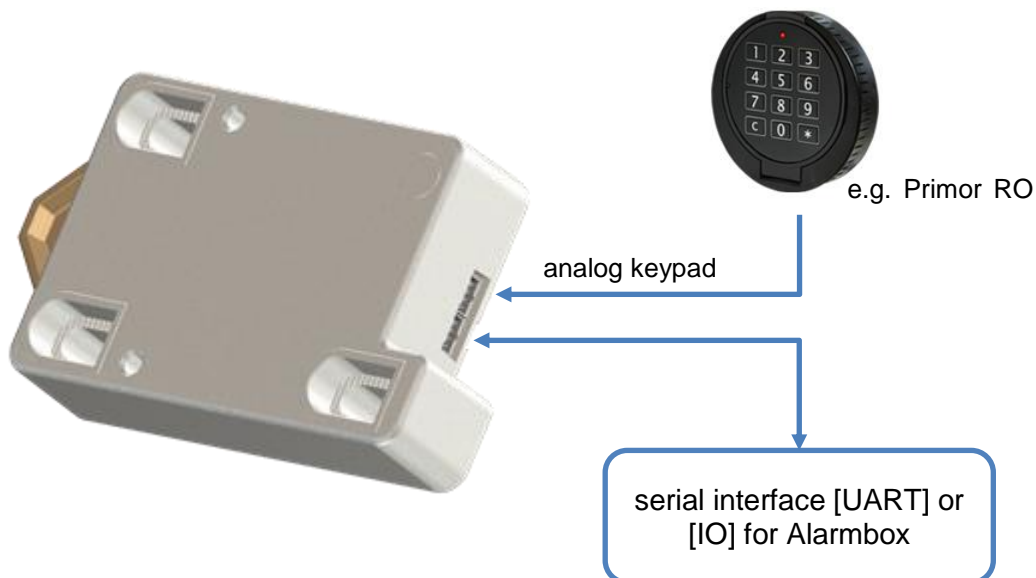

Connection P- signal plus / UART

Connection via the second port (see above) is always done if

- the lock system has an external power supply,
- a "silent alarm" contact for evaluation by an alarm system has been made available,
- a system block by an external signal (dry contact) is to be used.

Additional hardware is required to do this.

The lock is compatible with all the available components of the Primor series.

You can find information on the wiring in the instructions for the signal box. The VdS approval is no longer valid when used in conjunction with a signal box or if the serial interface (UART) is not used correctly.

If a signal block with "active release" (switching logic) has been set up this ensures that the blocking is not switched off if the control cable is cut through. At the same, a cable breakage within the safe always thus entails the risk of a blockade.

Function test

Carry out a function test after completing all the mounting and installation work. With the door open, you should open and close the lock several times using the master code that had been set at the factory.

The relationship between easy opening and reliable closing can be set via the operating lever of the boltwork.

The locking check can be done via the operating lever of the boltwork and should be performed after each closing and locking.

Input of the opening code

e.g. factory code Master

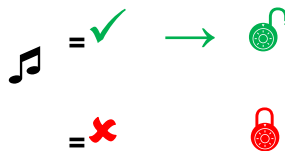
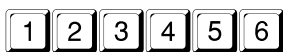

The opening code can be input directly as described above, without selection. After a valid code is input the lock releases the bolt movement for around 3 seconds. Open the container with the valuables within this time after inputting the code.

Keypad test

We recommend a final keypad test using function menu 5 to ensure that all the numeric keys function properly.



Checking the menu system

Press the keys in the sequence

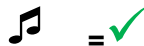

Press each numeric key once.

A functional key is indicated by a double signal tone.

A key that is not recognised is indicated by a long signal tone and the function test is terminated. The system must be checked.

System setup

The setting options and the control sequences that are required are described in the user manual.

We therefore recommend the following procedure:

- Setup of the users [menu 1]
- if applicable, parameterisation of the inputs and outputs [menu 6]
- if applicable, setting up the Dualcode condition [menu 6]
- if applicable, setting up the delay time [menu 9]

In particular, the user system can be made markedly faster by using setup mode [menu 8].
The repetitive input of the master code is then restricted to selecting setup mode.