

Note:

On the cover sheet you can find warning information, and an explanation of the symbols and terms used, together with the exclusion of liability.

Mount the keypad before installing the electronic lock. All the keypads of the Primor series can be used. For information on how to install the keypads, please refer to "Part 2a- Primor keypad installer manual".

Contents

General	2
Preparation for installation	3
Installation dimensions for lock 1600	3
Preparation of the boltwork / door	3
Installation	4
Wiring / installation	4
Function test.....	5
Input of the opening code	5
Keypad test	5

General

P1600 series locks have standard installation dimensions and can be installed in all 4 installation positions (right, left, top, bottom). They are designed for boltworks with a one-sided locking edge, i.e. only for force absorption by the straight boltwork flank of the quarter-circle-shaped bolt.

They are intended to be installed in safes made of metal.

The electronic lock requires no maintenance in a normal residential or office environment. We recommend a security and function test of the electronic lock after around 10,000 closings.

It is essential that the lock is protected against attacks from outside. We recommend that you protect against access the security-relevant parts of the high-security lock also when the door of the container that holds the valuables is open.

It is not permissible to use two locks of the same type in connection with analogue keypads without any additional components for locking state detection.

Do not apply any lubricants or other substances to the lock.

Ensure that the load limits are not exceeded at any time.

You can find the corresponding values in Annex C "Technical data".

Always use the following sequence for installation:

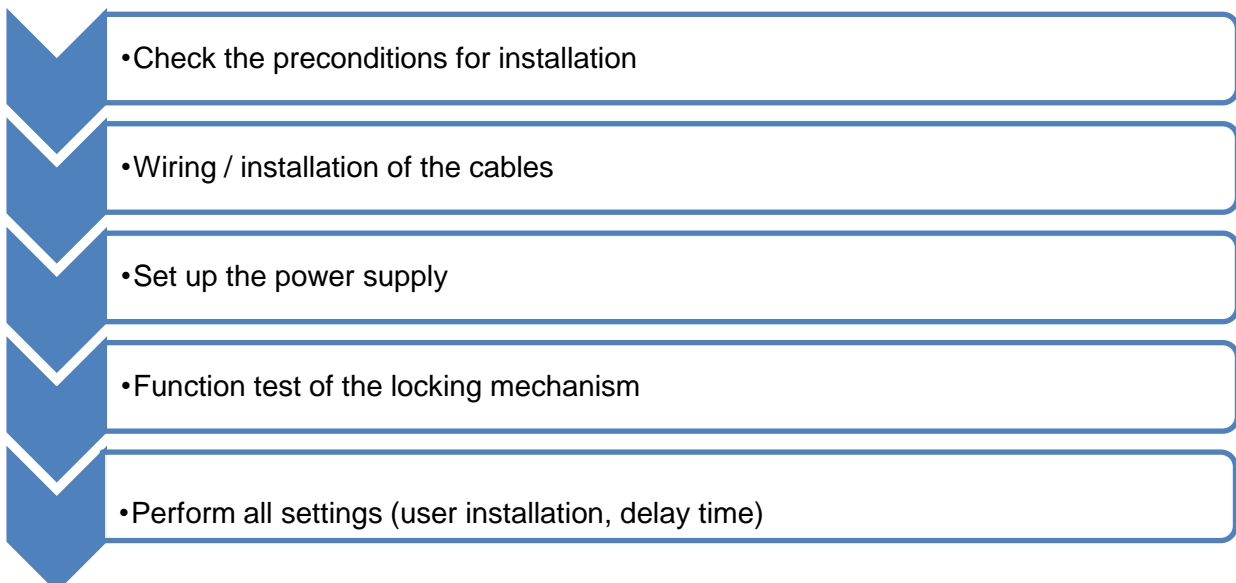

Preparation for installation

Installation dimensions for lock 1600

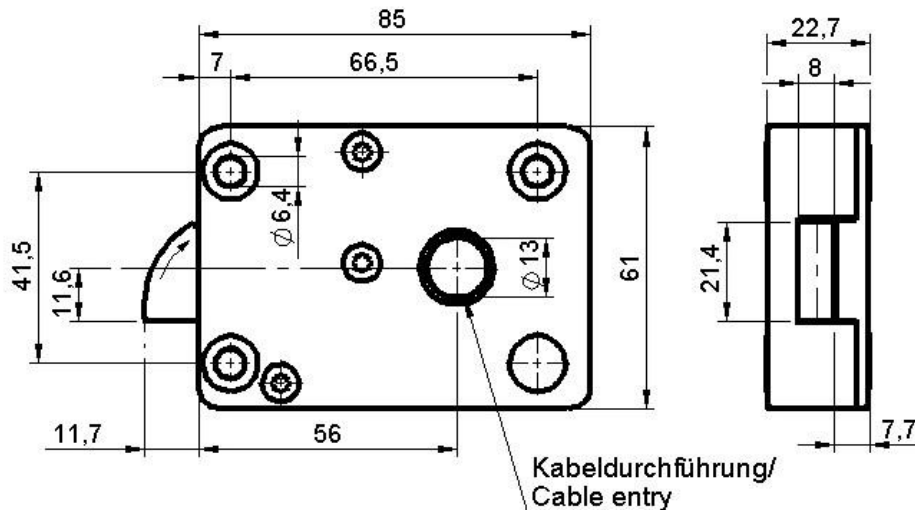

Preparation of the boltwork / door

To install the lock, there must be three threaded holes for fastening on the boltwork or inside the safe door. The electronic lock must be fastened with the supplied screws or M6 or 1/4" cylinder

screws (min. strength class 8.8). The screw length should be measured so that a minimum screw-in depth of 6 mm is possible.

Drilling pattern:

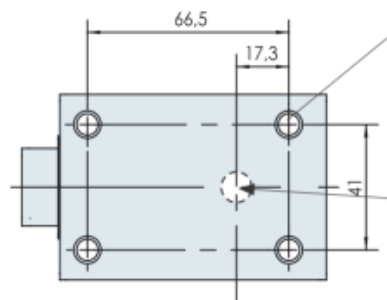

This hole is not required on Primor 1000 / 1600 / 2000.

Primor 100 / 2000: Centre of electronic lock drive is flush with centre of input unit (Primor RO)/centre of keypad lever (Primor RE)

The electronic lock can be installed in the area of openings with a maximum diameter of 11.5 mm around the axis centre shown above.

Installation

The retaining screws must be tightened in such a way that a permanent and firm hold is ensured.

Tighten the fastening screws with a maximum torque of 6 Nm. To prevent the screws from becoming loose, the screws must be secured using safety washers or using screw locking agents.

There must be no tension or pressure on the lock bolt after installation.

Make sure there is sufficient clearance to the locking point.

Wiring / installation

Cut off the power supply / battery, before starting any work or making any changes to the wiring between the lock and keypad.

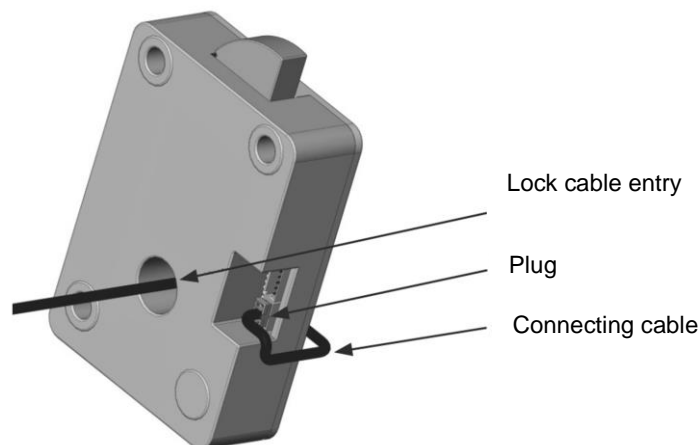

Function test

Carry out a function test after completing all the mounting and installation work. With the door open, you should open and close the lock several times using the master code that had been set at the factory.

The relationship between easy opening and reliable closing can be set via the operating lever of the boltwork.

The locking check can be done via the operating lever of the boltwork and should be performed after each closing and locking.

Input of the opening code

e.g. master factory code

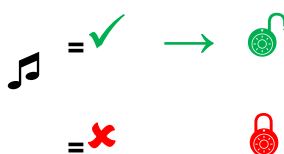
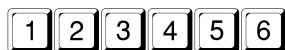

The opening code can be input directly as described above, without selection. The bolt is released for approx. 3 seconds after a valid code has been entered. Open the container with the valuables within this time after inputting the code.

Keypad test

We recommend a final keypad test using function menu 5 to ensure that all the numeric keys function properly.



Press the keys in the sequence

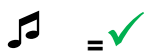

Press each numeric key once. A functional key is indicated by a double signal tone. A key that is not recognised is indicated by a long signal tone and the function test is terminated. The system must be checked.