

### Contents

- Mechanical key data..... 2
  - Dimensions..... 2
  - Weight..... 2
  - Permanent bolt load ..... 2
  - Installation screws ..... 2
  - Tightening torques..... 2
- Operating conditions ..... 3
  - Temperature..... 3
  - Relative humidity ..... 3
- Electrical key data ..... 3
  - Supply voltage..... 3

### Mechanical key data

#### Dimensions

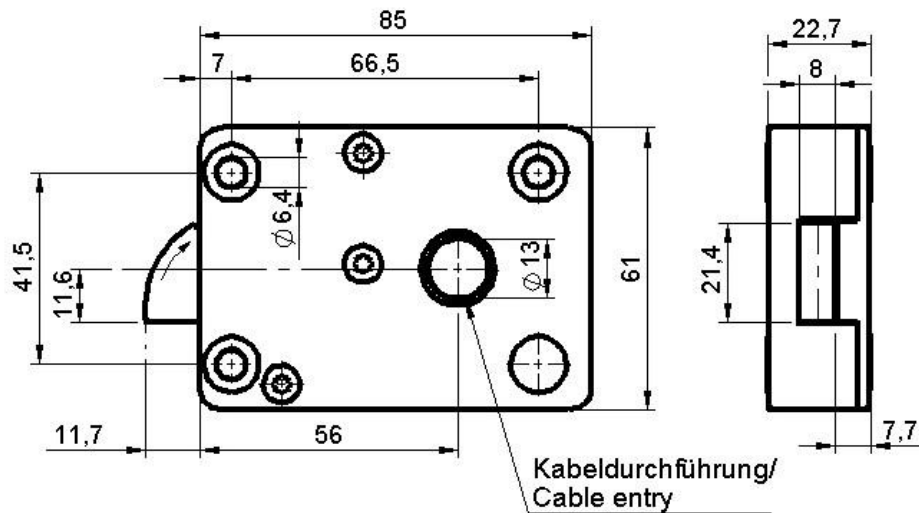

#### Weight

Lock weight approx. 375g

#### Permanent bolt load

The free movement of the bolt must be ensured during closing. No additional rods, brackets or similar additional elements may be attached to the bolt. The appropriate design measures must be taken to avoid transverse or frictional forces on the lock bolt. The locking force in the opening direction is tested at 1 kN. Higher blocking forces must be absorbed by implementing appropriate design solutions.

#### Installation screws

Cylinder head screws DIN EN ISO 4762 - M6x30-8.8 or alternatively  
3 cylinder head screws BSW 1/4 x 30 mm.

#### Tightening torques

6 Nm

### Operating conditions

The lock has been designed for fixed installation in containers for valuables or safe room doors in a residential or office environment.

### Temperature

10 °C – 40 °C

### Relative humidity

Relative humidity, non-condensing, should not exceed 75%.

### Electrical key data

### Supply voltage

The power is usually supplied by a 9V **alkaline-manganese** battery.