



Ivox series

Assembly instructions

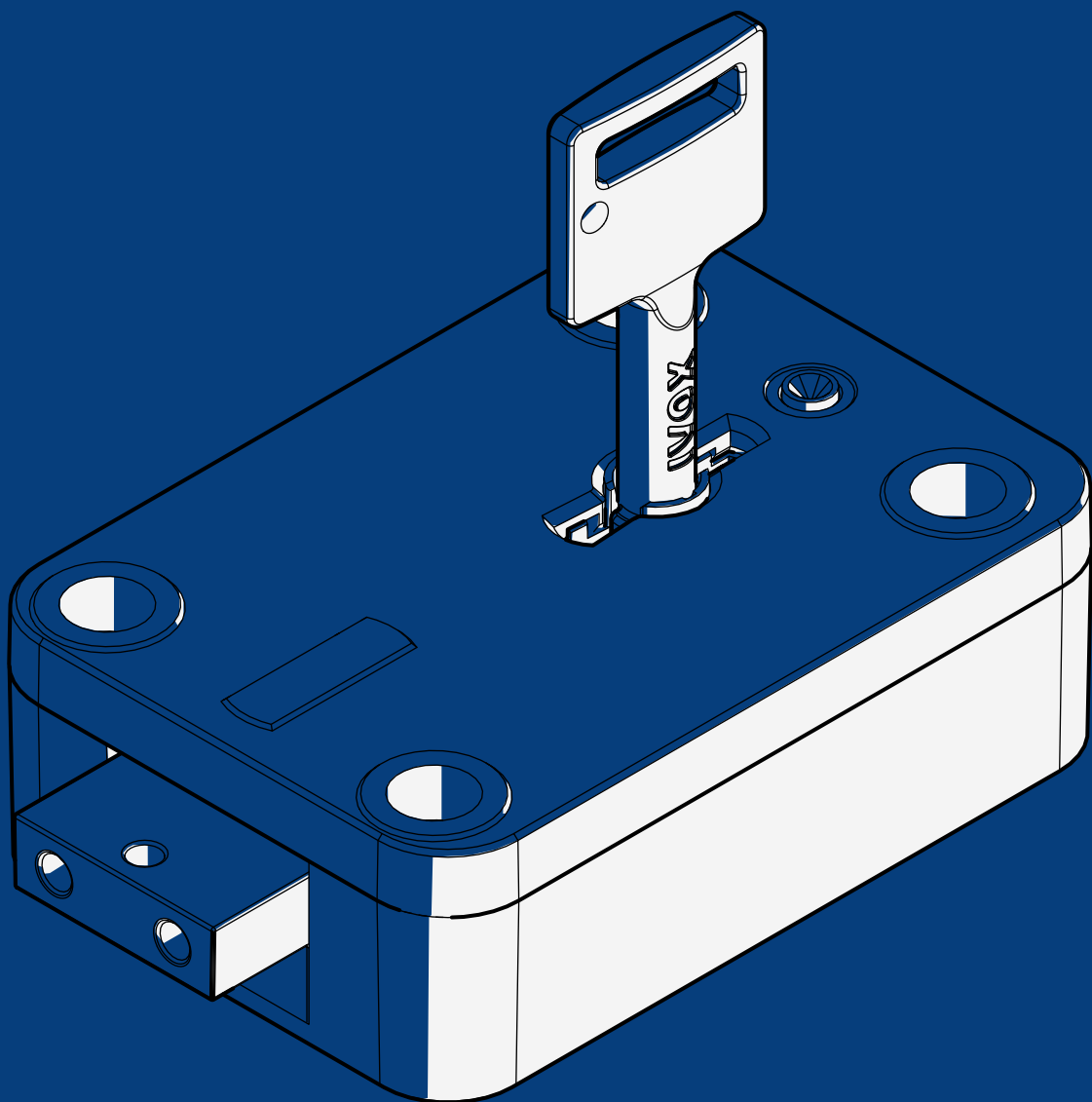

Table of contents

- General Information.....3
- Security advice.....3
- Lock installation.....3
- Connection to the boltwork.....3
- Specifications4
- Disclaimer5

In the following table, you will find a variant overview of the IVOX product groups:

Type numbers	Product group
4.19.95	1995
4.19.97	1997
4.19.97.A	1997A
4.19.98	1998

Please take the time to read this operating instructions carefully before using the lock.

1. General Information

- These assembly instructions serve as the basis for recognition by the VdS and other international testing institutes. Strict adherence is essential, as any deviation can result in the loss of approvals.
- IVOX safe locks are specially designed for use on the doors of safes. However, it is the responsibility of the user to ensure suitability and testing for the specific application.

2. Security advice

- The safe must be designed in such a way that there is no access to security-relevant parts of the lock for unauthorized persons when the door is open

3. Lock installation

- The safe should preferably be made of a steel construction capable of adequately securing the lock against drilling and tampering. The use of manganese steel and bracing the lock are effective measures to ensure increased security.
- The locks can be installed in safes made of all commercially available materials.
- IVOX locks have standard mounting dimensions and can be mounted both horizontally (right/left) and vertically (up/down).
- To ensure a reliable screw connection, locking washers or liquid screw securing agents are required. These measures prevent unintended loosening of the screw connection. Make sure that the screw-in depth complies with current standards.

4. Connection to the boltwork

- The exact positioning and fastening of the boltwork are crucial for the proper functioning of the IVOX lock. Both horizontal and vertical alignment must be precise.
- Connection to the boltwork or attachment of additional blocking elements should only be done through the three holes provided on the front face of the bolt head by the manufacturer.
- The bolt holes are suitable for self-tapping screws M4 DIN 7500.
- When using rods, angles or similar blocking elements connected to the bolt, lateral or frictional forces on the lock bolt must be avoided by design measures.
- The lock has been tested with an actuation force / bolt counterforce of 2.5 N over 10,000 closing cycles.

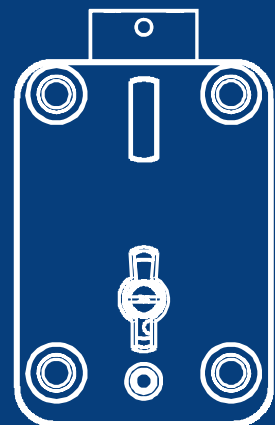

5. Specifications

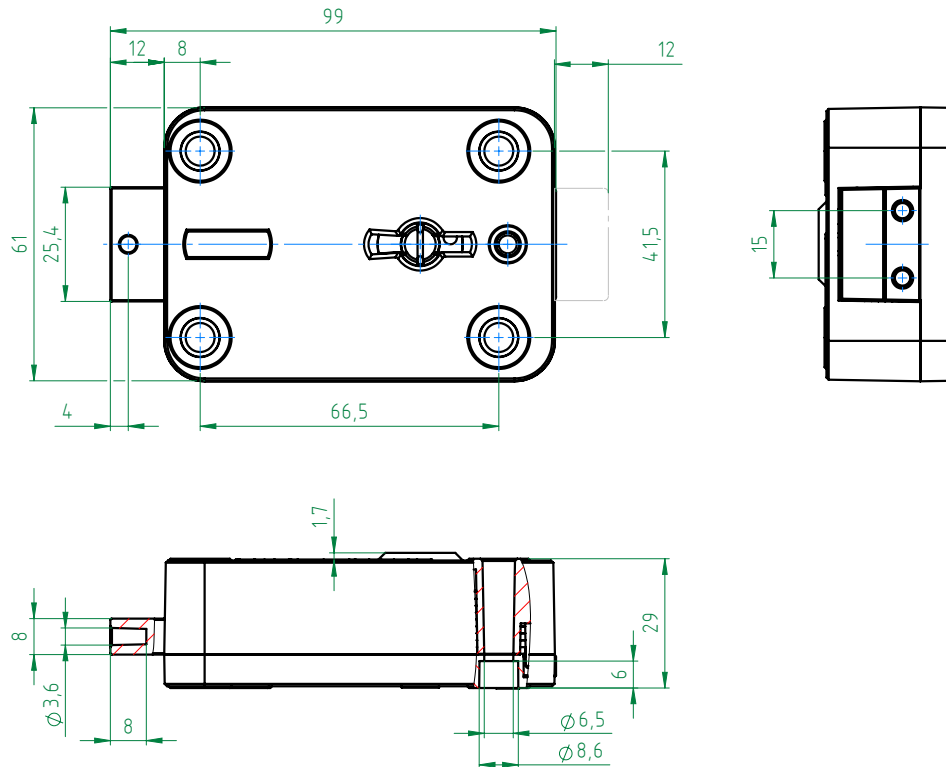

Bolt head dimensions (mm)	25,4 x 8 x 12 mm
Bolt holes	3 holes \varnothing 3.6 mm, suitable for self-tapping screws M4 DIN 7500
Bolt stroke (mm)	12 mm
Locking force	The locking force in the actuation direction and transverse to the bolt was tested at 1 kN. Higher forces are to be compensated by suitable measures, such as bracing the bolt.
Mounting screws	4 cylindric screws DIN EN ISO 4762 - M6 x 35mm 8.8 or 4 cylindric screws BSW 1/4" x 35 mm Grade 5
Screwing depth	According to the valid standards
Tightening torque	6 Nm

6. Disclaimer

The safe lock is intended exclusively for use on doors of safes. Any other use or modification of the lock that does not comply with the instructions provided by the manufacturer is at your own risk.

The lock must only be installed by qualified personnel and opened by the manufacturer to ensure proper functionality. Any unauthorized opening of the lock will result in the voiding of all warranty claims.

Any warranty or guarantee for the safe lock becomes void if the lock is mishandled, modified, or repaired by unauthorized personnel.

The manufacturer assumes no liability for any damage, loss or injury resulting from improper handling, installation, repair, or use of the safe lock.

The manufacturer takes no responsibility for the loss of valuables or documents stored within the safe secured with the safe lock. It is the user's responsibility to take appropriate security measures and regularly inspect the correct operation of the lock.



Serie IVOX
Assembly instructions

Carl WITTKOPP GmbH
Am Lindenkamp 57 • D-42549 Velbert
Telephone: +49 (0)2051 9566 0
Email: info@carl-wittkopp.com

